

FAG

2209-K-2RS-TVH-C3

Self-aligning ball bearing

Schaeffler ID:
0384725890030Self-aligning ball bearing 22..-K-2RS-TVH,
tapered bore taper 1:12, seals, plastic
cage

Technical information

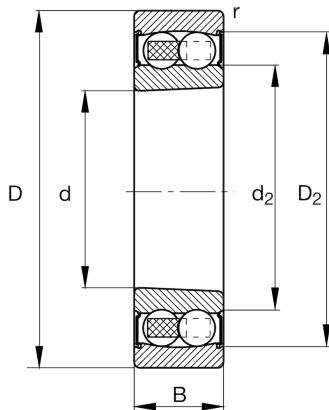

Main Dimensions & Performance Data

d	45 mm	Bore diameter
D	85 mm	Outside diameter
B	23 mm	Width
r_{\min}	1,1 mm	Minimum chamfer dimension
C_r	22.000 N	Basic dynamic load rating, radial
C_{0r}	7.300 N	Basic static load rating, radial
C_{ur}	465 N	Fatigue load limit, radial
n_G	4.650 1/min	Limiting speed
	0,527 kg	Weight

Dimensions

D_2	76 mm	Caliber diameter outer ring
d_2	53,8 mm	Caliber diameter inner ring

Mounting dimensions

$d_{a \min}$	52 mm	Minimum diameter shaft shoulder
$d_{a \max}$	57 mm	Maximum diameter shaft shoulder
$D_{a \max}$	78 mm	Maximum diameter of housing shoulder
$d_{b \min}$	48 mm	Minimum cavity diameter of the sleeve
$B_{a \min}$	5 mm	Minimum cavity width of the sleeve
$r_{a \max}$	1 mm	Maximum fillet radius

Calculation factors

e	0,21	Limiting value of F_a/F_r for the applicability of diff. Values of factors X and Y
Y_1	3,03	Dynamic axial load factor
Y_2	4,68	Dynamic axial load factor
Y_0	3,17	Static axial load factor

Additional information

H309	Adapter sleeve
------	----------------

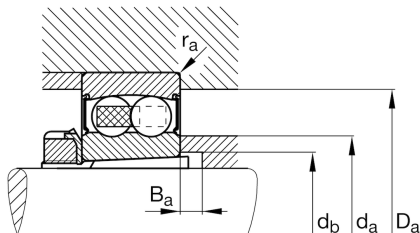
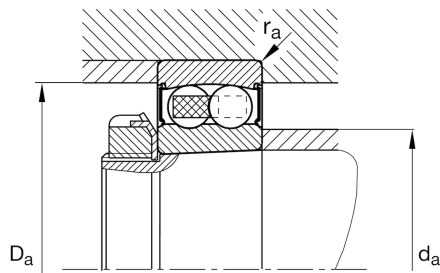

Temperature range

T_{\min}	-20 °C	Operating temperature min.
T_{\max}	100 °C	Operating temperature max.